

# Master Plan Options - Public Works

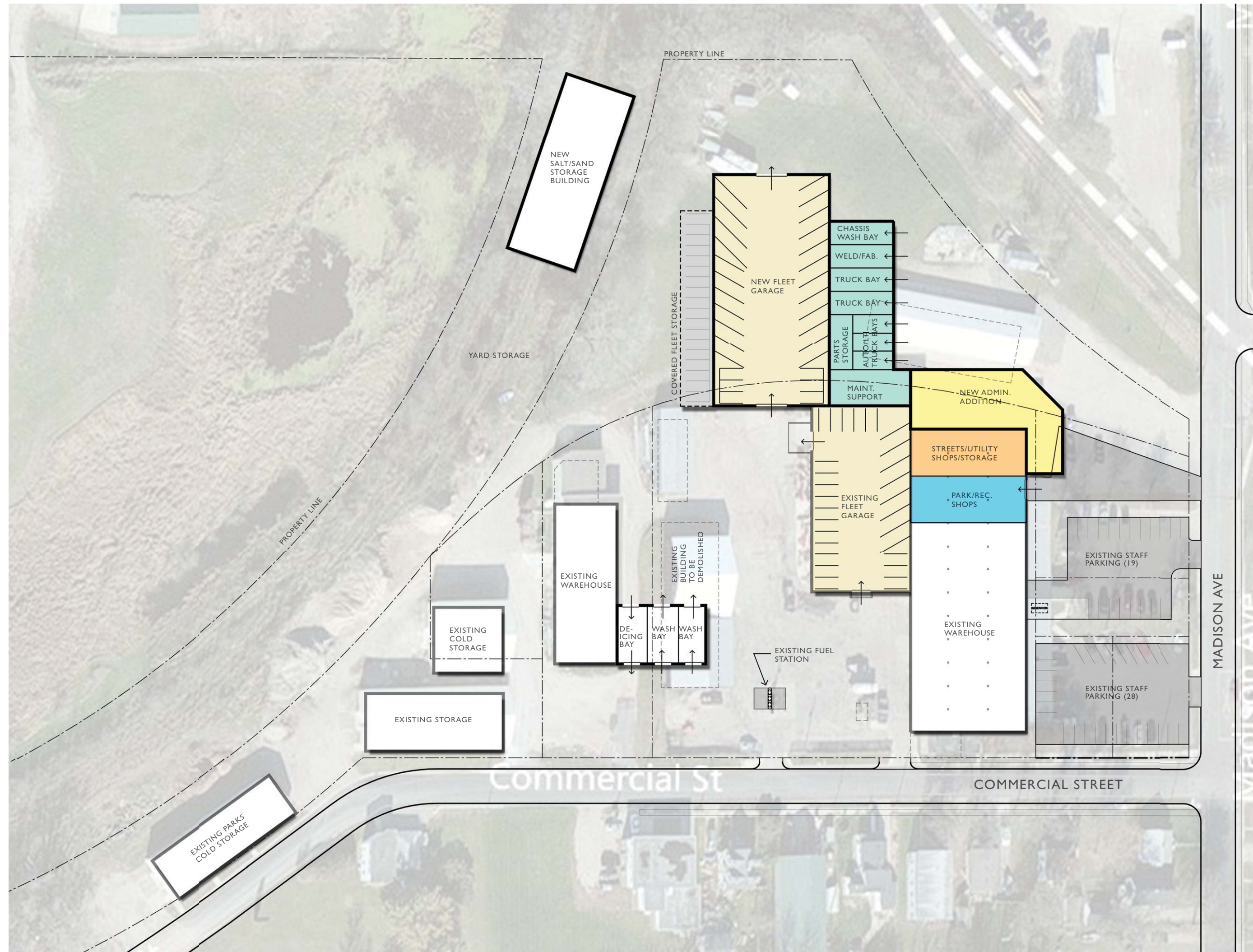

## Public Works - Option A

Expansion/Remodel of Existing Facility

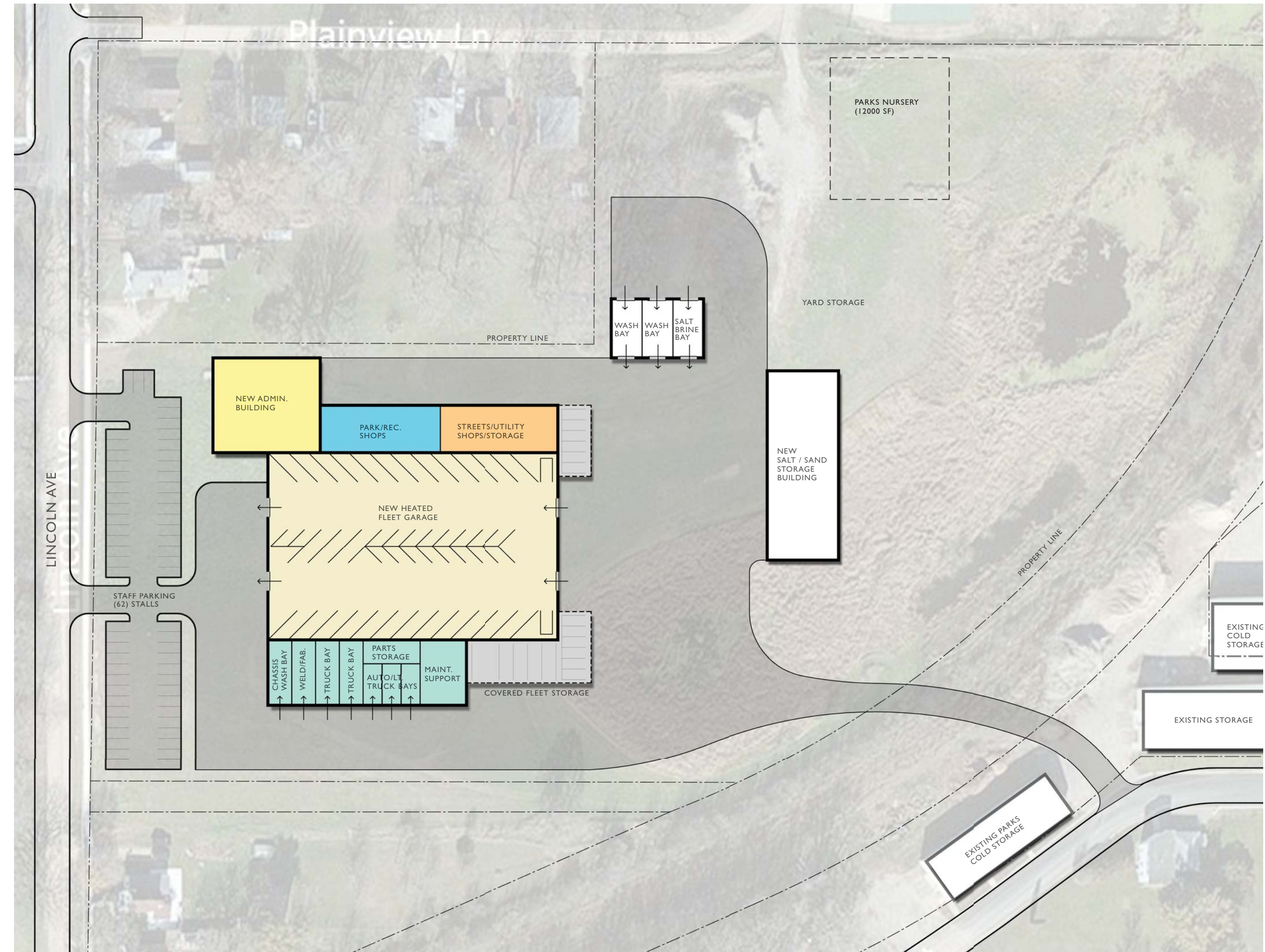

## Public Works - Option B

New Construction - West of Existing Facility at Lincoln Ave

## Programming Summary:

- Lack of adequate storage area
- Lack of fleet space (equipment stored outside)
- Inadequate fleet maintenance area
- Operational/functional relationships disjointed
- No locker areas provided
- Inadequate / Lacking required office & support spaces

## Conclusion:

Option A is the preferred option based on:

- Best utilization of existing buildings
- Operational proximity of warehouse areas
- Anticipated soil conditions / wetlands
- Allows for phased implementation
- Minimal earthwork / paving required
- Anticipated lower project cost

Existing: **63,620 gsf**  
 Proposed (2030): **88,324 gsf**

Note: Area does not include granular salt/sand storage.